

SURVEYOR'S RECORD

Section 6

Township 106

Range 39

6
7

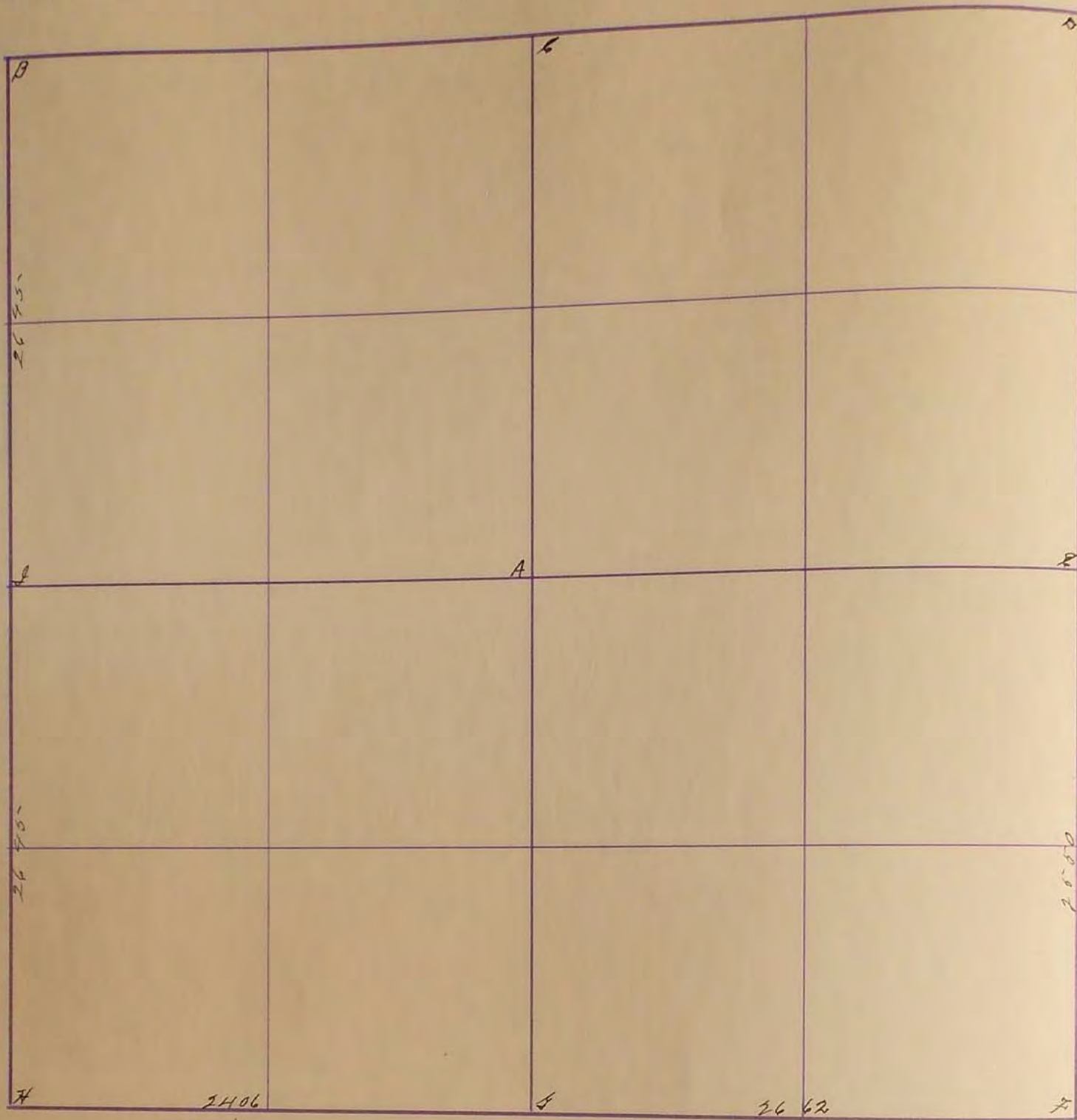

Oct. 15 1907

J. H. Hoelstene off

- H. Iron state fence line 24' N. F.L. 26' E.
N.C. in R.P. 40.40' N. Top Center of Conc. Culu. 50.13' S.E.
- C. Found Stone-placed Iron Rod over N.C. in 12" Ash Tree 66.68' S.S.E.
N.C. R.P. 33.89' West. N.C. in 5th F.P. N. of C.F.P. 57.45' N.W.
- I. Found Stone & Iron N.C. in F.P. 29.26' East.
- F Found 2" Iron Pipe - replaced with 1 1/2" ϕ x 1 1/2" Iron pipe N.C. in F.P. 67.43' S.E. N.C. in C.F.P. 30.45' N.
N.C. in F.P. 65.36' S.S.E.

SURVEY No. 1802

Section 6 Town 106 Range 39

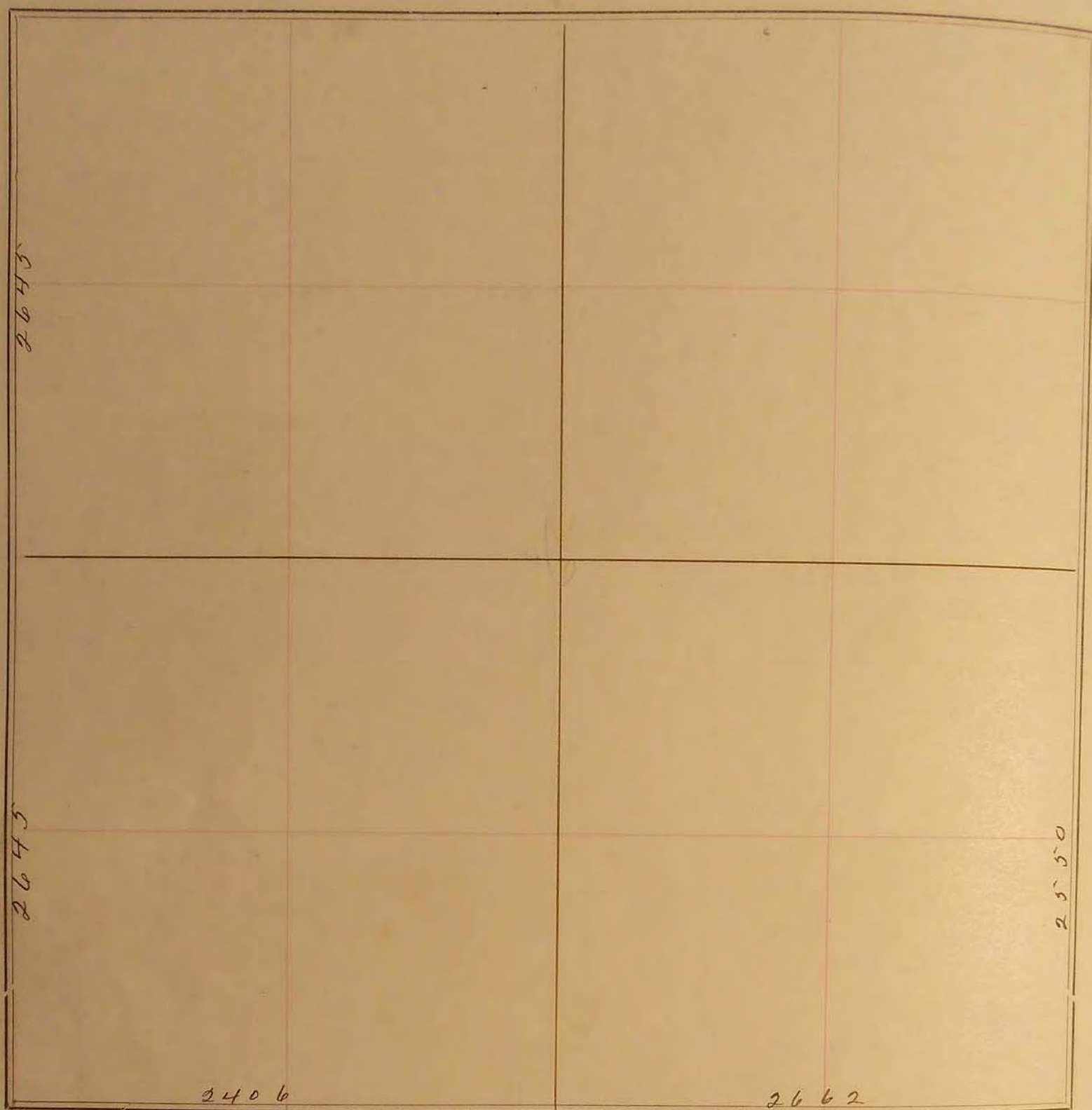

FIELD NOTES.

Oct. 15, 1907.

J. W. Woodstewart

H. Iron stake. Fence line 24' N, F.L. 26' E